

BLOCKS	H (FT)	B (FT)
5	3.18	15.0
6	3.81	12.0
7	4.45	11.0
8	5.08	10.0
9	5.72	9.00

CMU BLOCKS

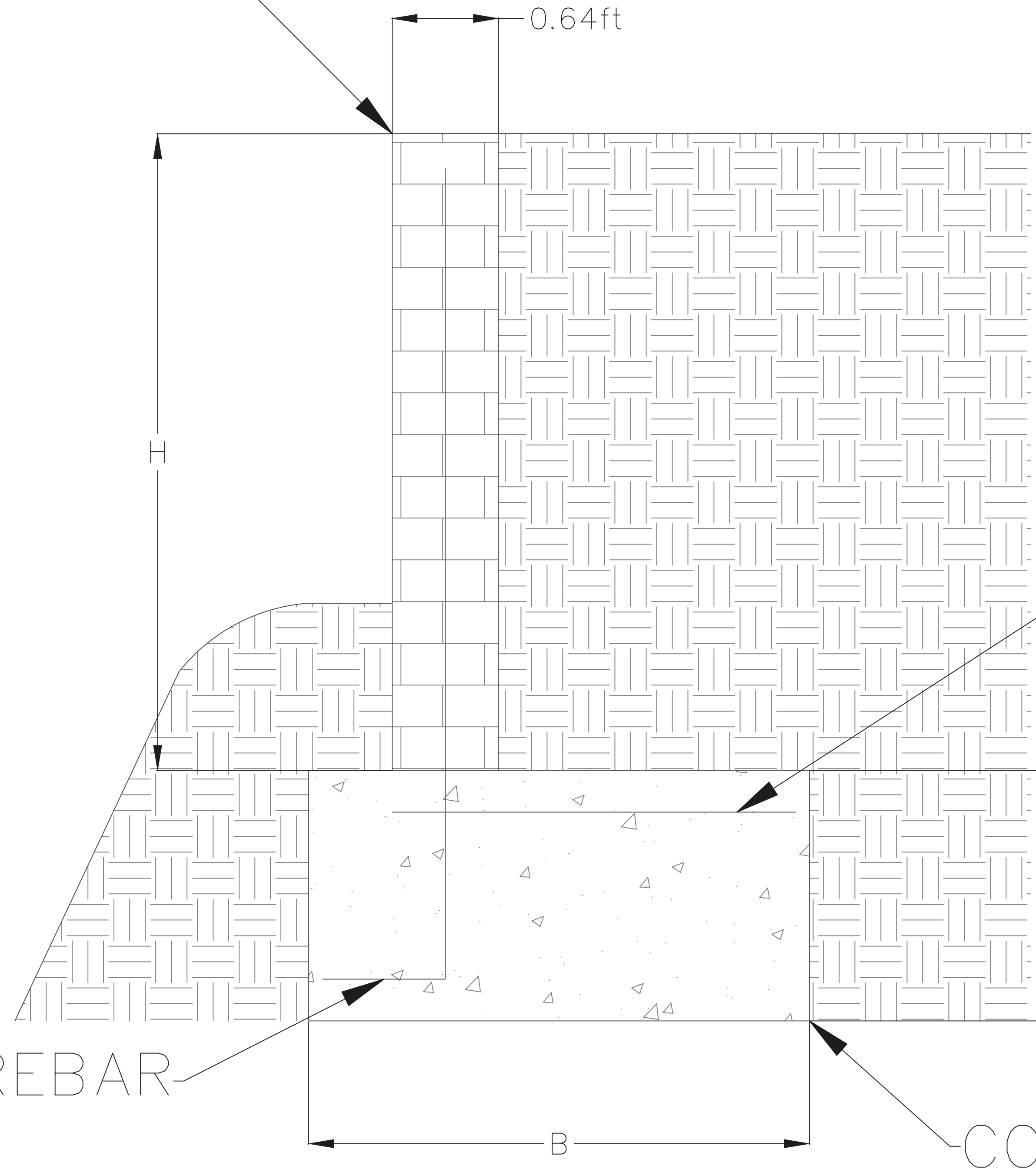

#5 REBAR

#5 REBAR

CONCRETE FOOTING



WALL E. WALLERSON & ASSOCIATES INC.

TEAM MEMBERS:

- CHRIS COOK
- JOSH ENDERSBY
- HUNTER SCHNOEBELEN

PROJECT NAME:

TRAX RETAINING WALL
WALL OPTION 3

PROJECT NUMBER:

19001

DRAWING:

CROSS-SECTION

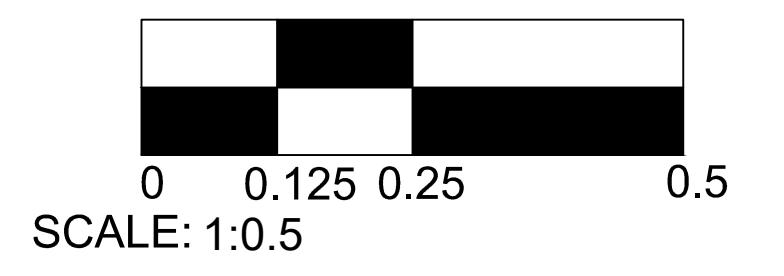

DRAWN BY: TEAM

DATE: 10/20/19

REVISION: 1

SUBMITTED: 12/06/19